

# Fiscal year 2018 Pre-release of power generation data

12 February 2019

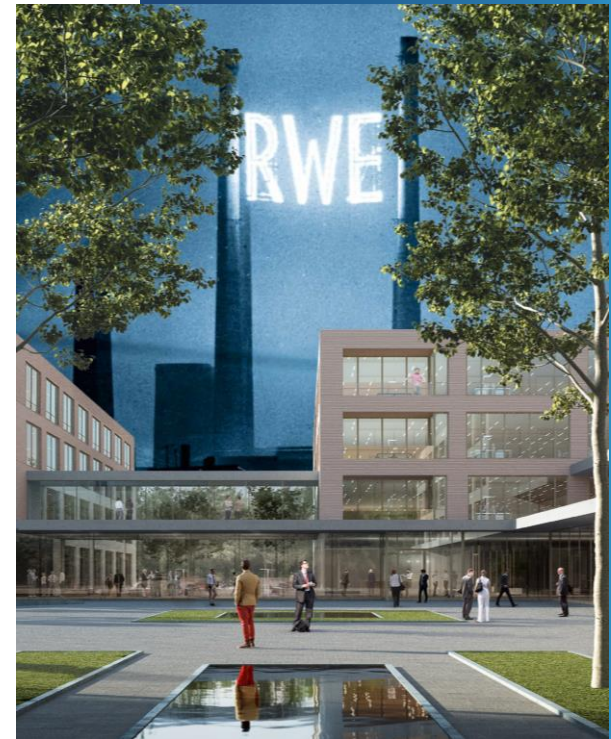

Powering. Reliable. Future.

**RWE**

# RWE's electricity generation January - December (Q1 - Q4)

**PREVIEW**

Billion kWh	Lignite		Hard coal		Gas		Nuclear		Renewables		Pumped storage, other		Total	
	2018	2017	2018	2017	2018	2017	2018	2017	2018	2017	2018	2017	2018	2017
<b>Lignite &amp; Nuclear</b>	<b>67,2</b>	<b>74,2</b>	-	-	-	-	<b>21,8</b>	<b>30,3</b>	-	-	<b>0,2</b>	<b>0,7</b>	<b>89,2</b>	<b>105,2</b>
of which														
Germany	66,0	69,5	-	-	-	-	20,8	29,4	-	-	0,2	0,7	87,0	99,6
Netherlands	-	-	-	-	-	-	1,0	0,9	-	-	-	-	1,0	0,9
Hungary	1,2	4,7	-	-	-	-	-	-	-	-	-	-	1,2	4,7
<b>European Power</b>	-	-	<b>27,4</b>	<b>29,3</b>	<b>47,2</b>	<b>52,9</b>	-	-	<b>1,1</b>	<b>1,1</b>	<b>2,3</b>	<b>2,4</b>	<b>78,0</b>	<b>85,7</b>
of which														
Germany <sup>1</sup>	-	-	13,0	13,3	5,5	7,4	-	-	0,7	0,7	2,3	2,4	21,5	23,8
United Kingdom	-	-	0,5	2,6	33,2	32,4	-	-	0,4	0,4	-	-	34,1	35,4
Netherlands/Belgium	-	-	13,9	13,4	5,5	9,3	-	-	-	-	-	-	19,4	22,7
Turkey	-	-	-	-	3,0	3,8	-	-	-	-	-	-	3,0	3,8
<b>innogy-continuing operations</b>	-	-	-	-	-	-	-	-	<b>8,8</b>	<b>9,3</b>	-	-	<b>8,8</b>	<b>9,3</b>
<b>RWE Group</b>	<b>67,2</b>	<b>74,2</b>	<b>27,4</b>	<b>29,3</b>	<b>47,2</b>	<b>52,9</b>	<b>21,8</b>	<b>30,3</b>	<b>9,9</b>	<b>10,4</b>	<b>2,5</b>	<b>3,1</b>	<b>176,0</b>	<b>200,2</b>

<sup>1</sup> Including electricity from power plants not owned by RWE that we can deploy at our discretion on the basis of long-term agreements. In fiscal year 2018, this amounted to 5.0 billion kWh (fiscal year 2017: 6.3 billion kWh) of which 2.3 billion kWh from hard coal (2017: 3.5 billion kWh).

- > Lower lignite power generation due to lignite reserve (Frimmersdorf P (284 MW) and Q (278 MW) since Q4 17; Niederaußem E (295 MW) and F (299 MW) since Q4 18
- > Hungarian lignite power generator Mátra reported under 'assets held for sale' since Q2 2017; disposal closed in Q1 2018
- > Hard coal: Closure of German Voerde A/B (1,390 MW) as of 1 April 2017; UK Aberthaw (1,560 MW) changed to primarily capacity market operation in April 2017
- > Gas Germany: margin related lower electricity generation
- > Gas Netherlands: Moerdijk 1 (339 MW) power plant mothballed since January 2018
- > Lower nuclear generation due to closure of Gundremmingen B (1,284 MW) as of 31 December 2017

# RWE's electricity generation October - December (Q4)

**PREVIEW**

Billion kWh	Lignite		Hard coal		Gas		Nuclear		Renewables		Pumped storage, other		Total	
	2018	2017	2018	2017	2018	2017	2018	2017	2018	2017	2018	2017	2018	2017
<b>Lignite &amp; Nuclear</b>	<b>14,8</b>	<b>17,9</b>	-	-	-	-	<b>6,1</b>	<b>7,9</b>	-	-	<b>0,1</b>	<b>0,2</b>	<b>21,0</b>	<b>26,0</b>
of which														
Germany	14,8	16,5	-	-	-	-	5,8	7,6	-	-	0,1	0,2	20,7	24,3
Netherlands	-	-	-	-	-	-	0,3	0,3	-	-	-	-	0,3	0,3
Hungary	-	1,4	-	-	-	-	-	-	-	-	-	-	-	1,4
<b>European Power</b>	-	-	<b>7,1</b>	<b>6,0</b>	<b>13,1</b>	<b>13,3</b>	-	-	<b>0,2</b>	<b>0,3</b>	<b>0,5</b>	<b>0,7</b>	<b>20,9</b>	<b>20,3</b>
of which														
Germany <sup>1</sup>	-	-	3,2	2,9	1,9	1,8	-	-	0,1	0,2	0,5	0,7	5,7	5,6
United Kingdom	-	-	0,1	-	9,0	8,6	-	-	0,1	0,1	-	-	9,2	8,7
Netherlands/Belgium	-	-	3,8	3,1	1,3	2,4	-	-	-	-	-	-	5,1	5,5
Turkey	-	-	-	-	0,9	0,5	-	-	-	-	-	-	0,9	0,5
<b>innogy-continuing operations</b>	-	-	-	-	-	-	-	-	<b>2,5</b>	<b>3,1</b>	-	-	<b>2,5</b>	<b>3,1</b>
<b>RWE Group</b>	<b>14,8</b>	<b>17,9</b>	<b>7,1</b>	<b>6,0</b>	<b>13,1</b>	<b>13,3</b>	<b>6,1</b>	<b>7,9</b>	<b>2,7</b>	<b>3,4</b>	<b>0,6</b>	<b>0,9</b>	<b>44,4</b>	<b>49,4</b>

<sup>1</sup> Including electricity from power plants not owned by RWE that we can deploy at our discretion on the basis of long-term agreements. In Q4 2018, this amounted to 1.2 billion kWh (Q4 2017: 1.4 billion kWh) of which 0.6 billion kWh from hard coal (Q4 2017: 0.6 billion kWh).

- > Lower lignite power generation due to lignite reserve (Niederaußem E (295 MW) and F (299 MW) since Q4 2018
- > Hungarian lignite power generator Mátra reported under 'assets held for sale' since Q2 2017; disposal closed in Q1 2018
- > Lower lignite power generation due to unplanned outages in Q4 2018
- > Gas Netherlands: Moerdijk 1 (339 MW) power plant mothballed since January 2018
- > Lower nuclear generation due to closure of Gundremmingen B (1,284 MW) as of 31 December 2017