



Environmental Design & Research,
Landscape Architecture, Engineering
& Environmental Services, D.P.C.

217 Montgomery Street, Suite 1000
Syracuse, New York 13202
P. 315.471.0688



everpower

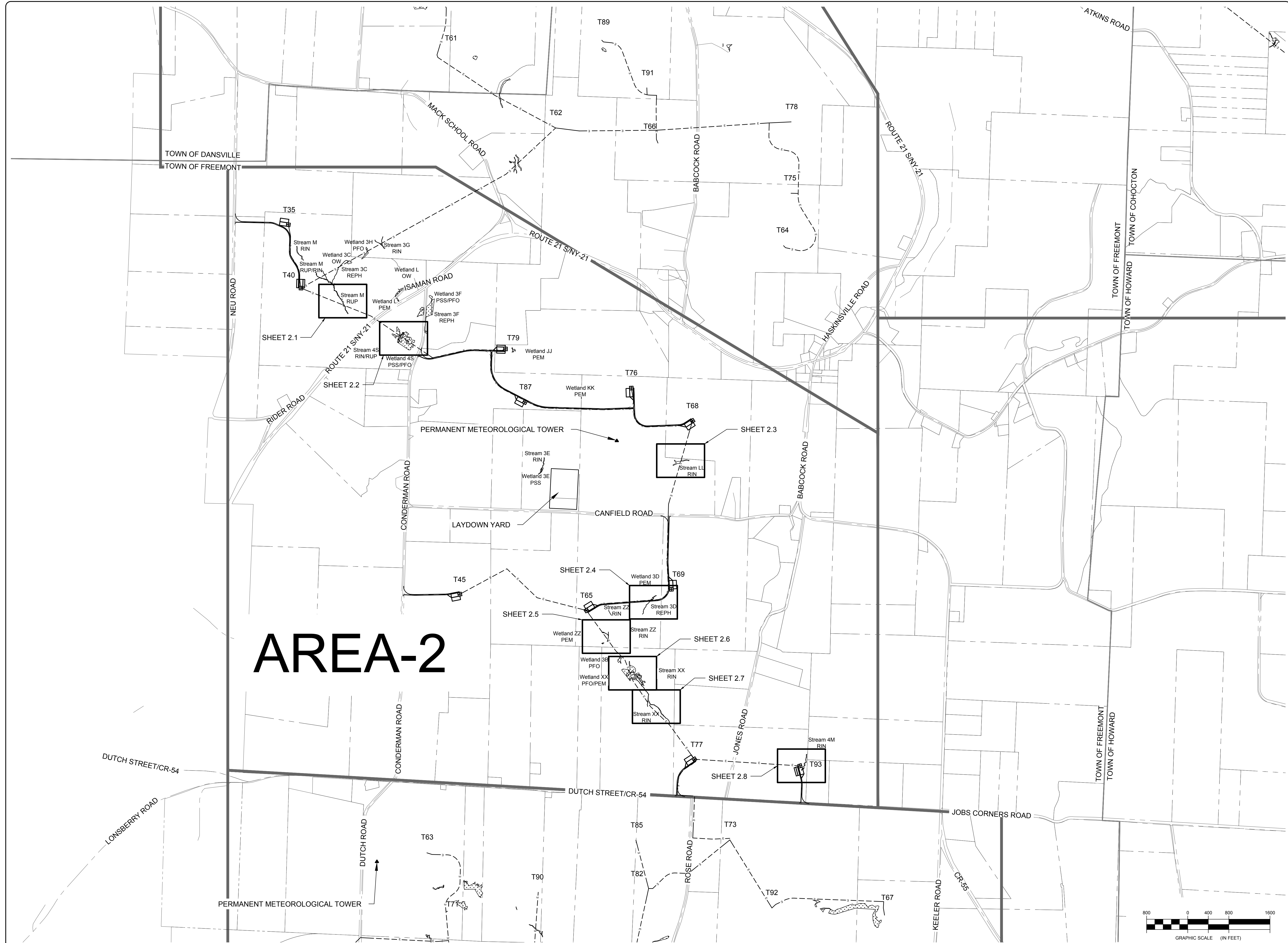

AREA-2

©2017 Environmental Design & Research, Landscape Architecture, Engineering & Environmental Services, D.P.C. The following is prepared for the Town of Conchocton, Steuben County, New York. This is a preliminary drawing and is not to be used for any other purpose without the written consent of Environmental Design & Research, Landscape Architecture, Engineering & Environmental Services, D.P.C. The user of this drawing assumes all liability for any errors or omissions. The user of this drawing warrants that the user has read and understands the disclaimer of the preparer.

DRAWING REVISIONS	
NO.	DATE

PROJECT TITLE:	BARON WINDS PROJECT
PROJECT LOCATION:	TOWNS OF CONCHOCTON, DANSVILLE, FREMONT, AND WAYLAND - STEUBEN COUNTY, NEW YORK
CLIENT:	EVERPOWER WIND HOLDINGS
DRAWING TITLE:	AREA 2 WETLAND/STREAM IMPACT OVERVIEW

DATE:	NOVEMBER 17, 2017
SCALE:	SEE SCALE BAR
EDR JOB#: 13039	
DRAWN BY:	AW, JT, TS, PR
FILE NAME:	13039_Impacts_Area 2.dwg
DRAWING NUMBER:	OVERVIEW 2

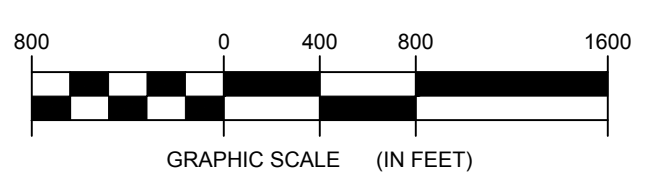

SHEET 2.1

Notes:
1. Horizontal directional drilling will be used to cross the southern portion of Stream M, and therefore no impacts will occur.

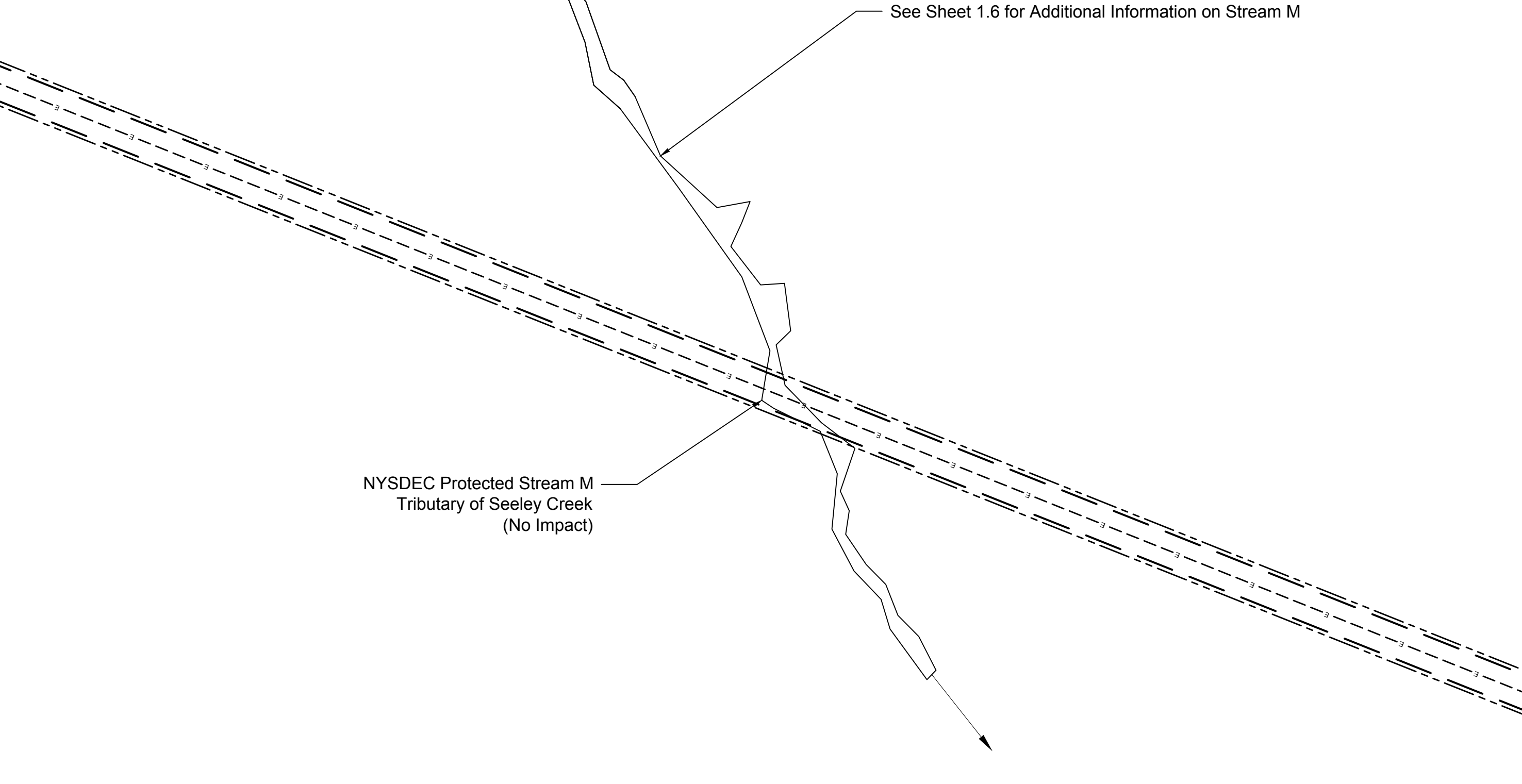

SHEET 2.2

Notes:
1. Horizontal directional drilling will be used to cross Wetland and Stream 4S, and therefore no impacts will occur.

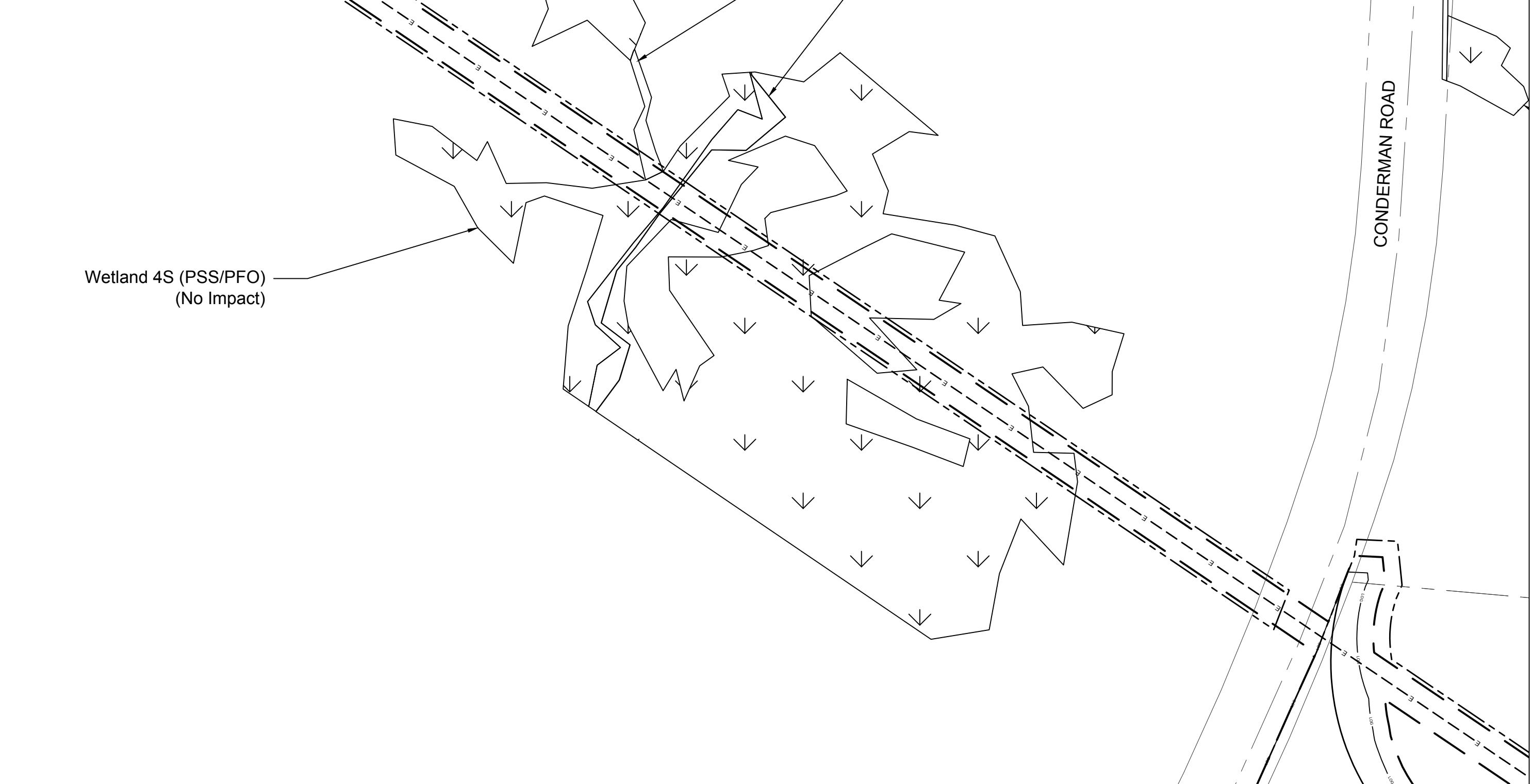

SHEET 2.3

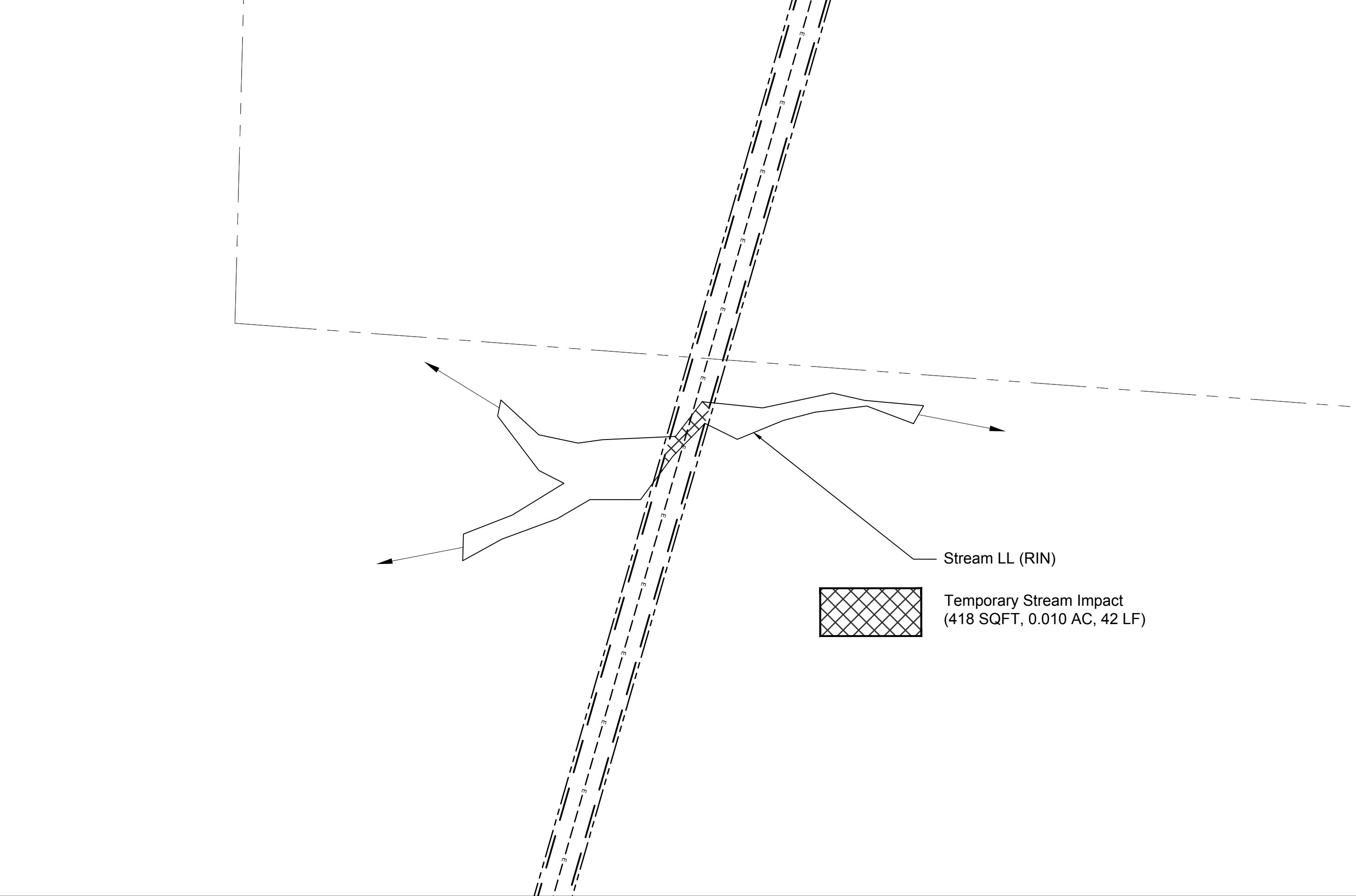

SHEET 2.4

Notes:
1. A culvert will be installed in the stream and will be designed in accordance with NWP General Condition G-A.11.

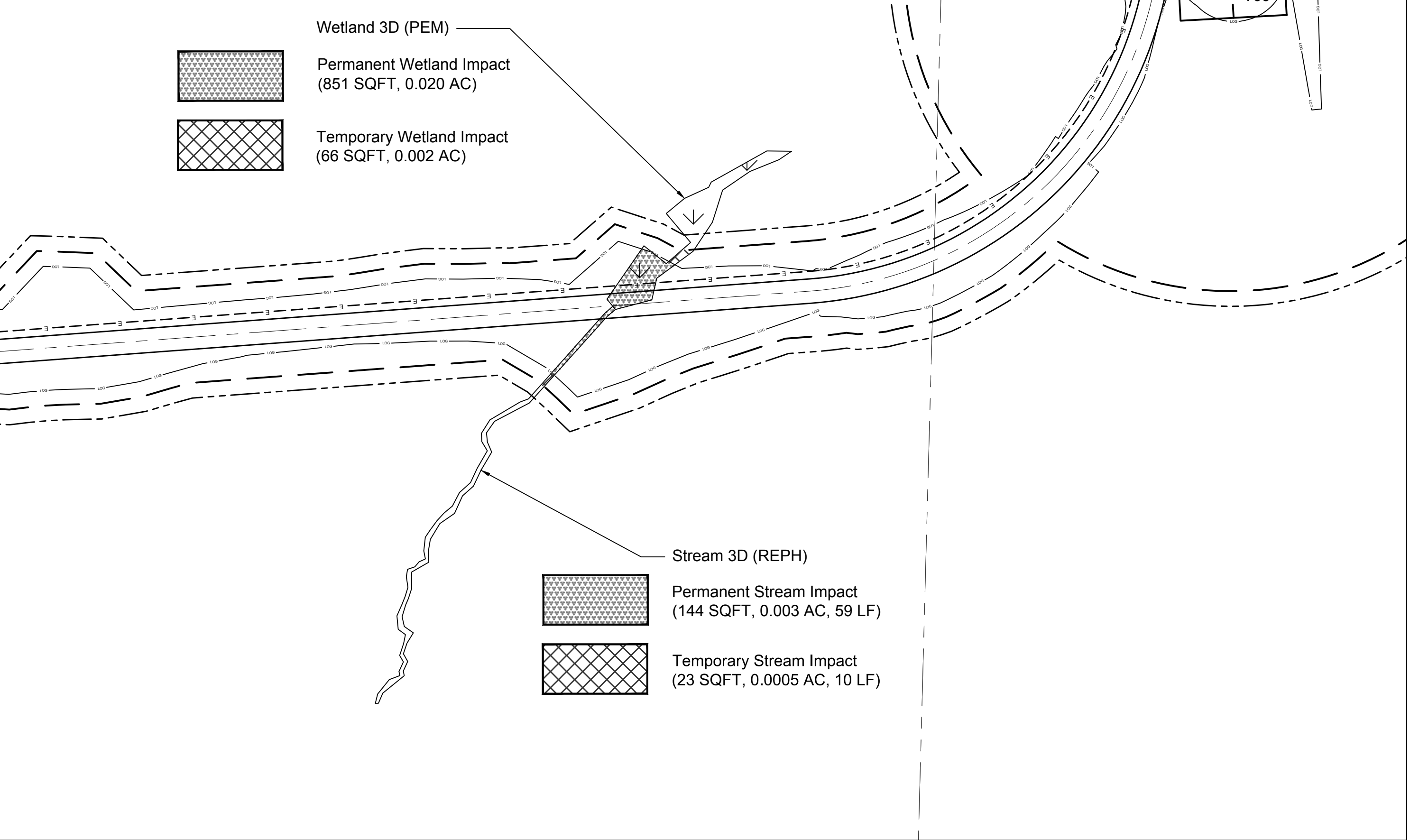

LEGEND
--- Underground Collection Line --- Limits of Grading --- Limits of Vegetation Clearing
--- Overhead Collection Line --- Limits of Soil Disturbance --- Wetland/Stream Continues

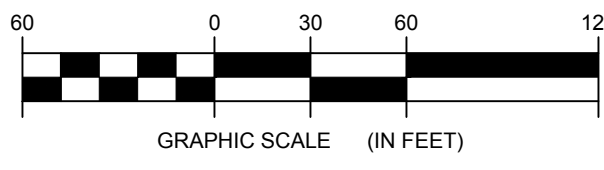

edr
Environmental
Design & Research,
Landscape Architecture, Engineering
& Environmental Services, D.P.C.
217 Montgomery Street, Suite 1000
Syracuse, New York 13202
P. 315.471.0688



DRAWING REVISIONS	
NO.	DATE

EDR Environmental Design & Research, Landscape Architecture, Engineering & Environmental Services, D.P.C. The following is prepared in accordance with the NYS Education Law, Section 1707.4, and applied to this drawing. This is a preliminary drawing and is not to be used for construction or other purposes without the written approval of the designer. The designer assumes no liability for any errors or omissions in this drawing, and the user assumes all liability for any such errors or omissions.

DRAWING REVISIONS	
NO.	DATE

PROJECT TITLE: **BARON WINDS PROJECT**
TOWNS OF CHICOCTON, DANVILLE, FRENCHTON, AND WATLAND -
PROJECT LOCATION: STEUBEN COUNTY, NEW YORK
CLIENT: EVERPOWER WIND HOLDINGS
DRAWING TITLE: AREA 2 WETLAND/STREAM IMPACT OVERVIEW

DATE: **NOVEMBER 17, 2017**
SCALE: **SEE SCALE BAR**
EIR JOB#: 13039
DRAWN BY: **AW, JT, TS, PR**
FILE NAME: 13039_Impacts_Area 2.dwg
DRAWING NUMBER: **2.1-2.4**

11/17/2018 Baron Winds Project/Impacts/Stream Impact/Sheet 2.1.dwg

SHEET 2.5

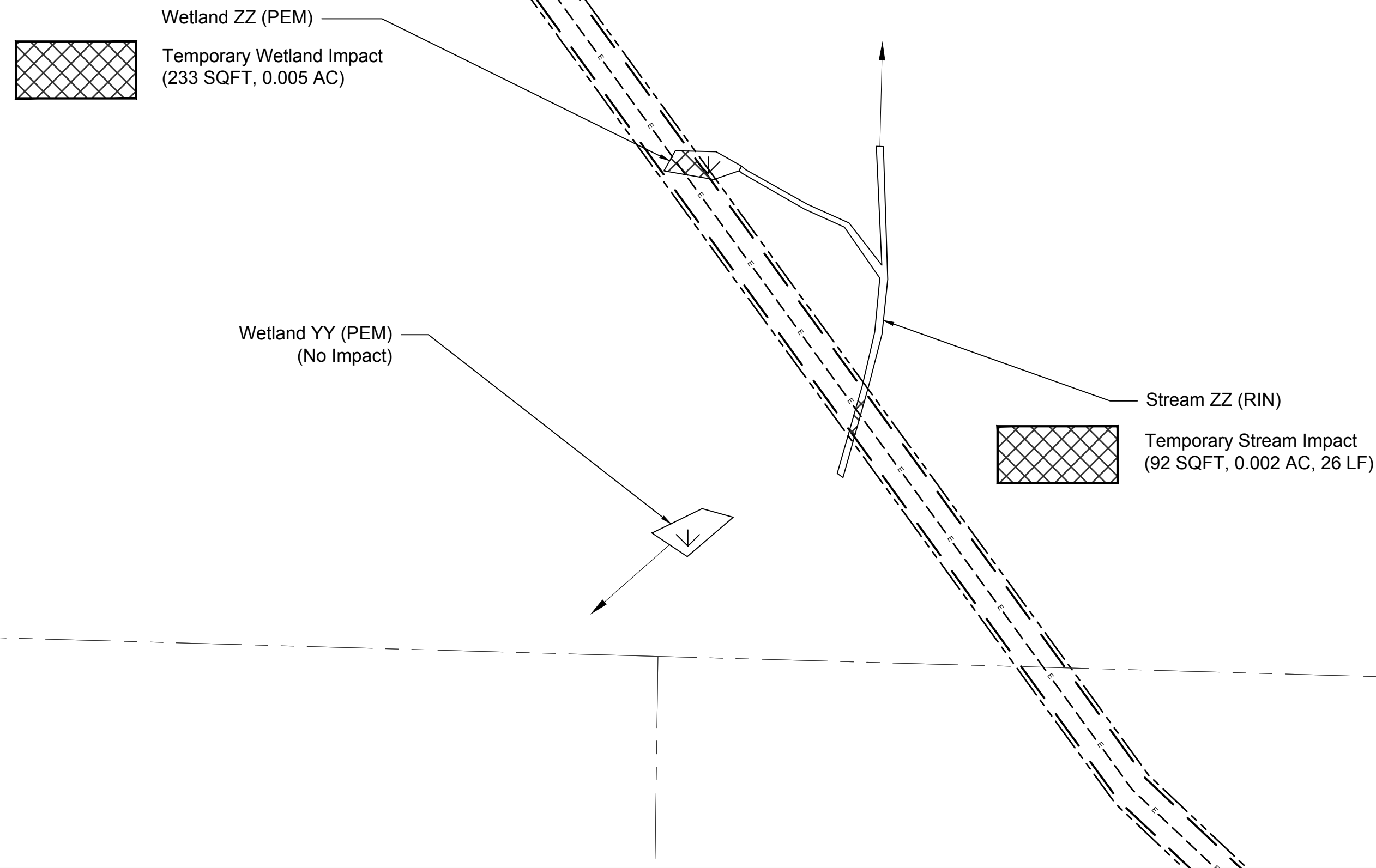

SHEET 2.6

Notes:
1. Horizontal directional drilling will be used to cross Wetland XX, and therefore no impacts will occur.

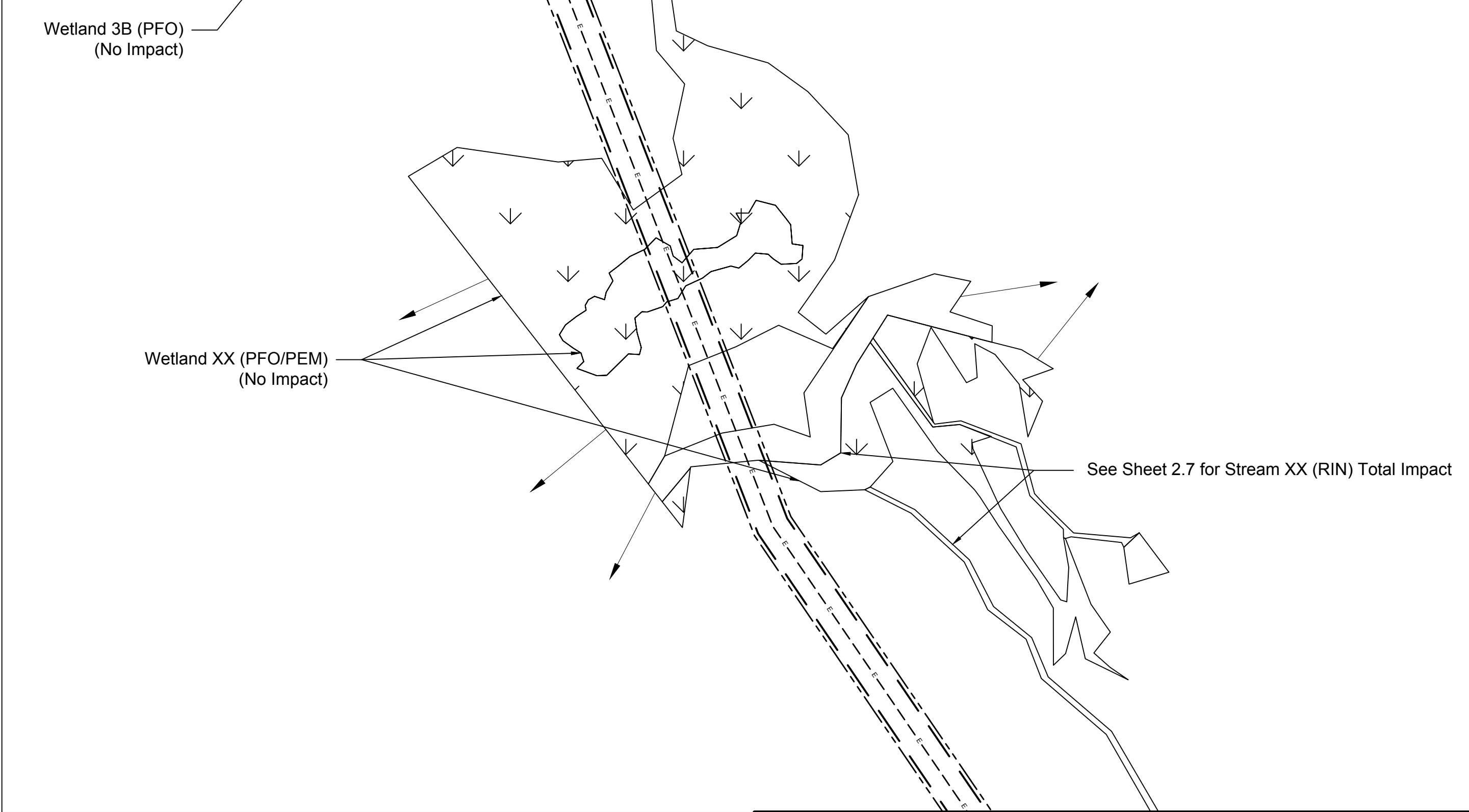

SHEET 2.7

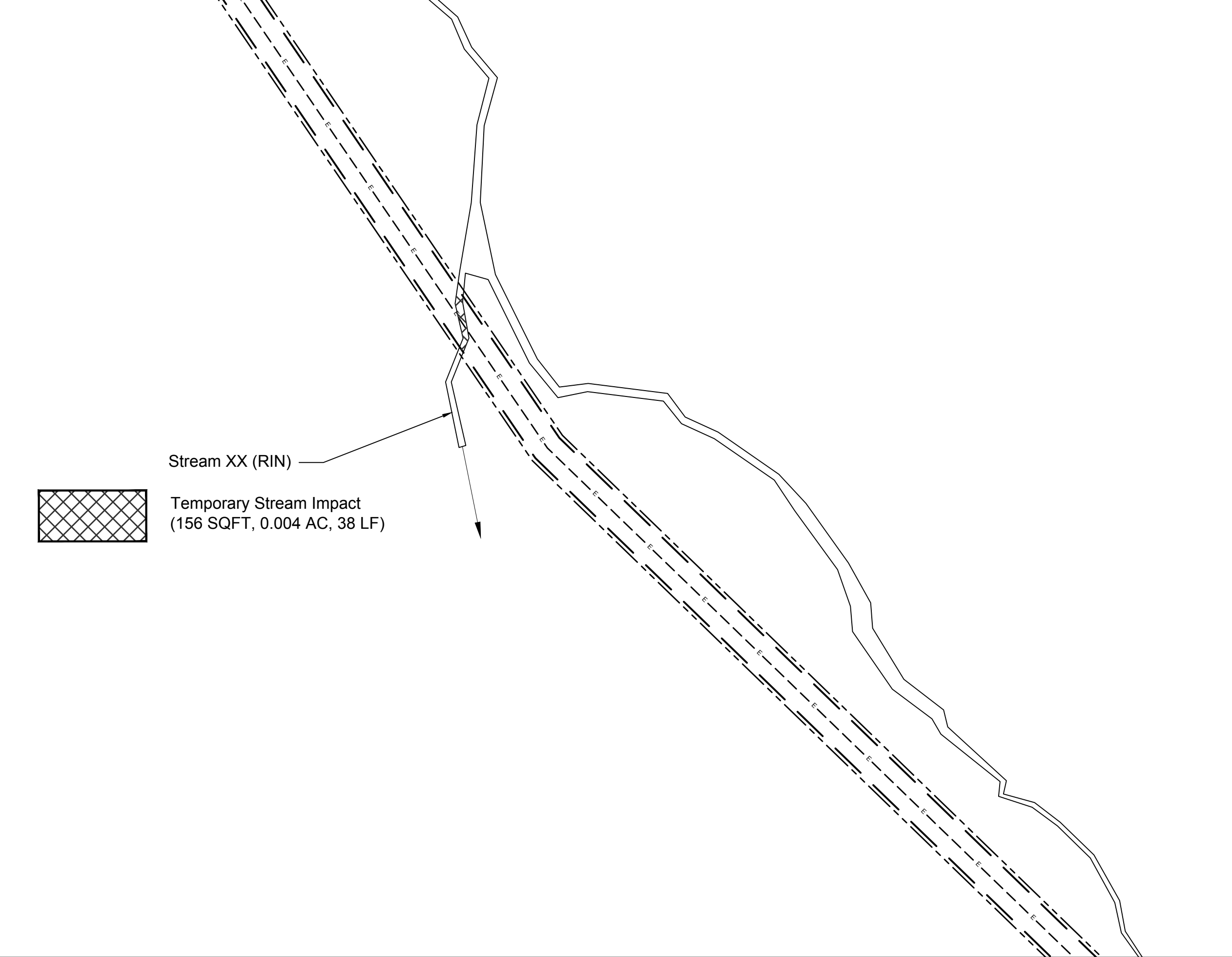

SHEET 2.8

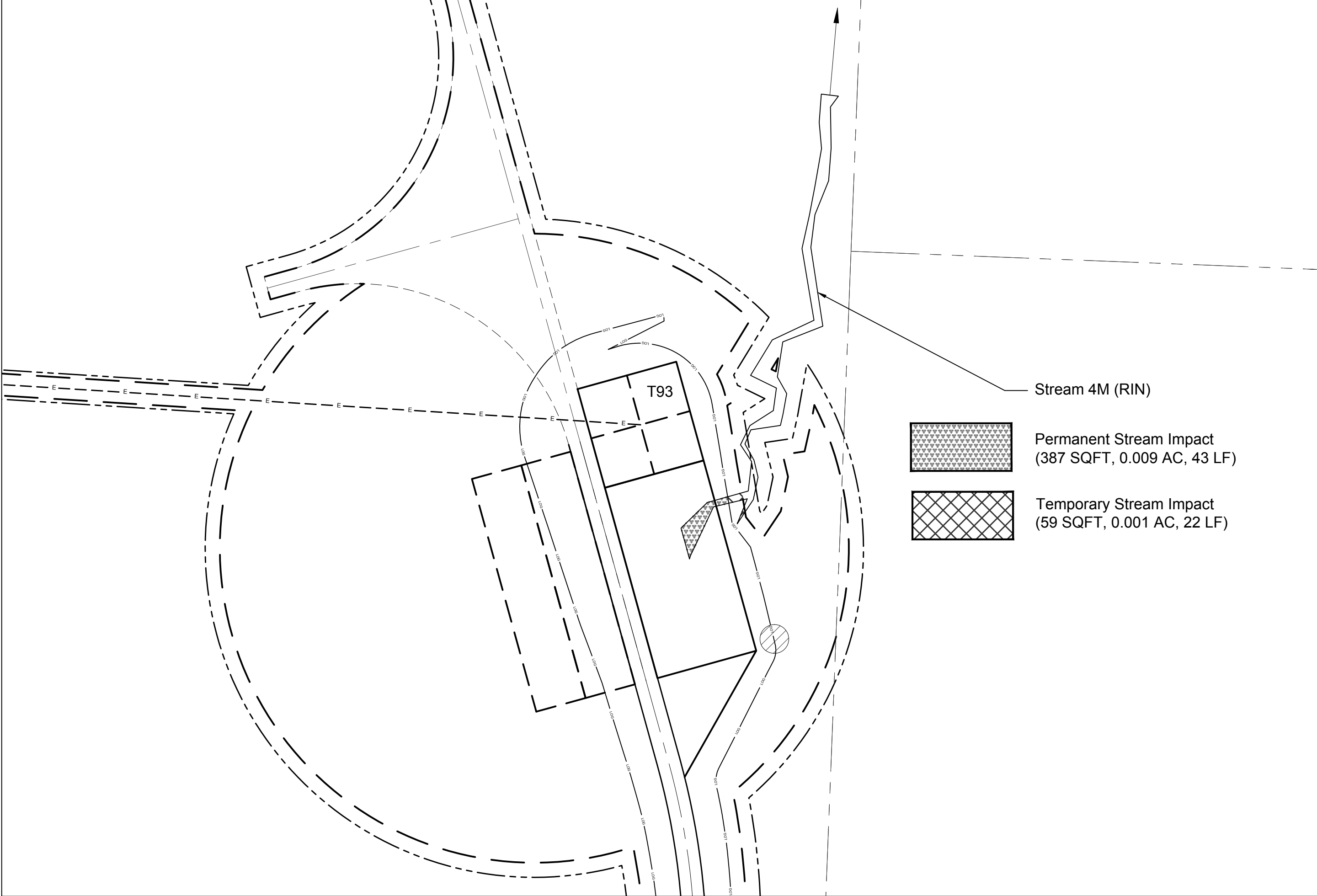

LEGEND
 - - - - - Underground Collection Line - - - - - Limits of Grading - - - - - Limits of Vegetation Clearing
 - - - - - Overhead Collection Line - - - - - Limits of Soil Disturbance - - - - - Wetland/Stream Continues

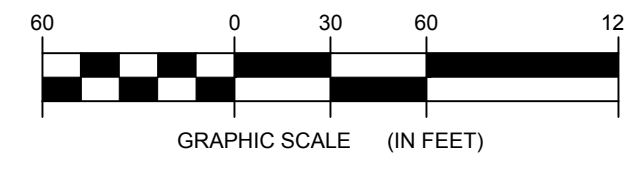

Environmental Design & Research,
 Landscape Architecture, Engineering & Environmental Services, D.P.C.
 217 Montgomery Street, Suite 1000
 Syracuse, New York 13202
 P. 315.471.0688



NO.	DATE	REVISION

©2017 Environmental Design & Research, Landscape Architecture, Engineering & Environmental Services, D.P.C. The following is prepared for the use of the Client and is not to be used for any other purpose without the written consent of Environmental Design & Research, Landscape Architecture, Engineering & Environmental Services, D.P.C. The Client acknowledges that the use of this information is at their own risk and that the information is not to be used for any other purpose without the written consent of Environmental Design & Research, Landscape Architecture, Engineering & Environmental Services, D.P.C.

PROJECT TITLE: BARON WINDS PROJECT
TOWNS OF COHOCTON, DANVILLE, FRENCHT, AND WATLAND - STEUBEN COUNTY, NEW YORK
CLIENT: EVERPOWER WIND HOLDINGS
DRAWING TITLE: AREA 2 WETLAND/STREAM IMPACT OVERVIEW

DATE: **NOVEMBER 17, 2017**
 SCALE: **SEE SCALE BAR**
 I&E: **13039**
 DRAWN BY: **AW, JT, TS, PR**
 FILE NAME: **13039_Impacts_Area 2.dwg**
 DRAWING NUMBER: **2.5-2.8**

1/13/2018 Baron Winds Project/Architectural/Impacts/Impacts Area 2.dwg